

Leasing Opportunity

Marlin Commercial Center

Address: 10675 SW 190 Street Miami, FL 33157

**Units Ranging:
532 SF.- 1,200 SF.**



Nestled in the heart of the South Dade Commercial District is Marlin Commercial Center, having been developed in 2008 and consisting of 65 units, this industrial-flex and office project is made up of three buildings fronting 190 Street.

More specifically, there are 25 office units having an average size of 631 (SF) and 40 industrial-flex units having an average size of 1,146 SF.

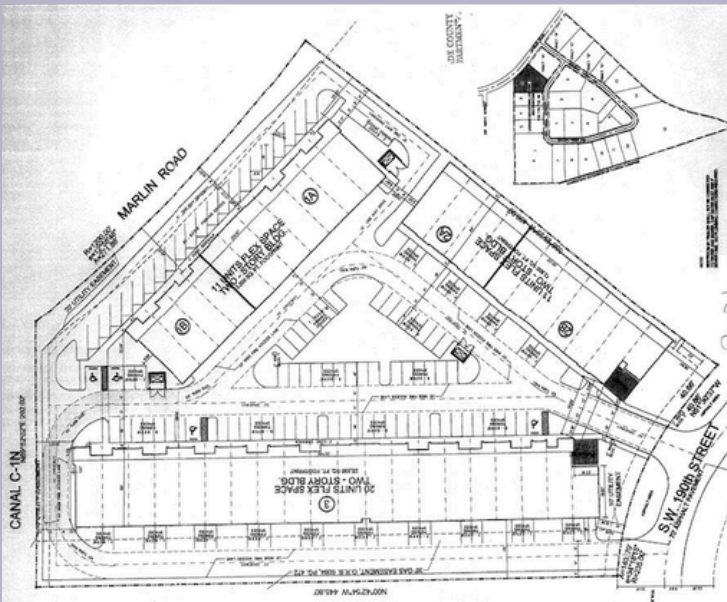

- Zoning: IU-1
- Year Built: 2006
- Gross Leasable Area: 61,079 Sq.Ft



For additional information please contact Hector Gutierrez EQUITY GROUP
305-527-7170 or Hector.Gutierrez@imcequitygroup.com